

Mini Dehumidifier WDH-898MD

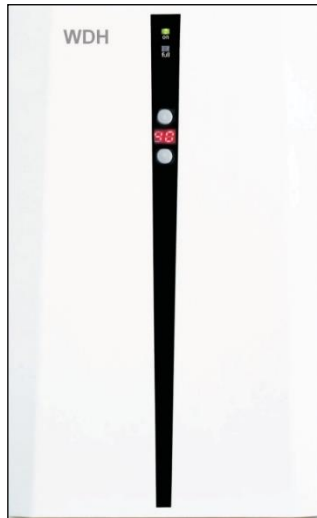

Dear Customer,

You have chosen a high-quality product. To ensure that you get a lot of enjoyment from this product, here are a few more tips:

In case of any problems:

We hope that the unit meets your expectations! If, despite the greatest possible care, there should ever be cause for complaint, please contact us briefly, as we are very concerned about your satisfaction and would like to clear up any misunderstanding.

During the first operation:

As the internal pipelines come into contact with moisture for the first time, it can take a few hours for the first liquid to accumulate in the collection container, depending on the humidity.

Room humidity and dehumidification performance:

If you want to check the room humidity and the associated dehumidification performance with your own humidity meter (hygrometer), please avoid attaching this humidity meter to a wall, as this will falsify the true humidity content of the room air. See also the explanations under **Troubleshooting !!!**

Important safety instructions:

- Supervise the dehumidifier when children are near the appliance !
- Watch out for electricity, never walk into or insert objects into the appliance !
- Do not block the exhaust air fins of the unit and please ensure sufficient space/clearance at and around the fan !
- Ensure that there is sufficient air supply to the unit, otherwise it can lead to a reduction in performance and, in the worst case, to overheating !
- Only qualified personnel or electricians are allowed to open the unit !
- Make sure that no moisture gets to the electrics of the unit !
- Only use the recommended voltage for operating the unit !
- Make sure that the power cable is unfolded (untied) before connecting it to the socket !
- Make sure that the plug is cleanly and properly connected to the socket before using the appliance !
- Never reach near the plug or socket with wet hands !
- Do not repair defective or damaged cables on the unit yourself, you could get a severe electric shock !
- Make sure that highly flammable substances (e.g. gases/oils etc.) are never in the vicinity of the unit !
- If you are not going to use the unit for a long time, switch it off and disconnect the mains plug !

Please switch off the unit immediately and disconnect it from the mains/power supply if anything seems to be wrong !!! In this case, please contact a specialist and do not attempt to repair the unit yourself !!!

Description of the unit parts:

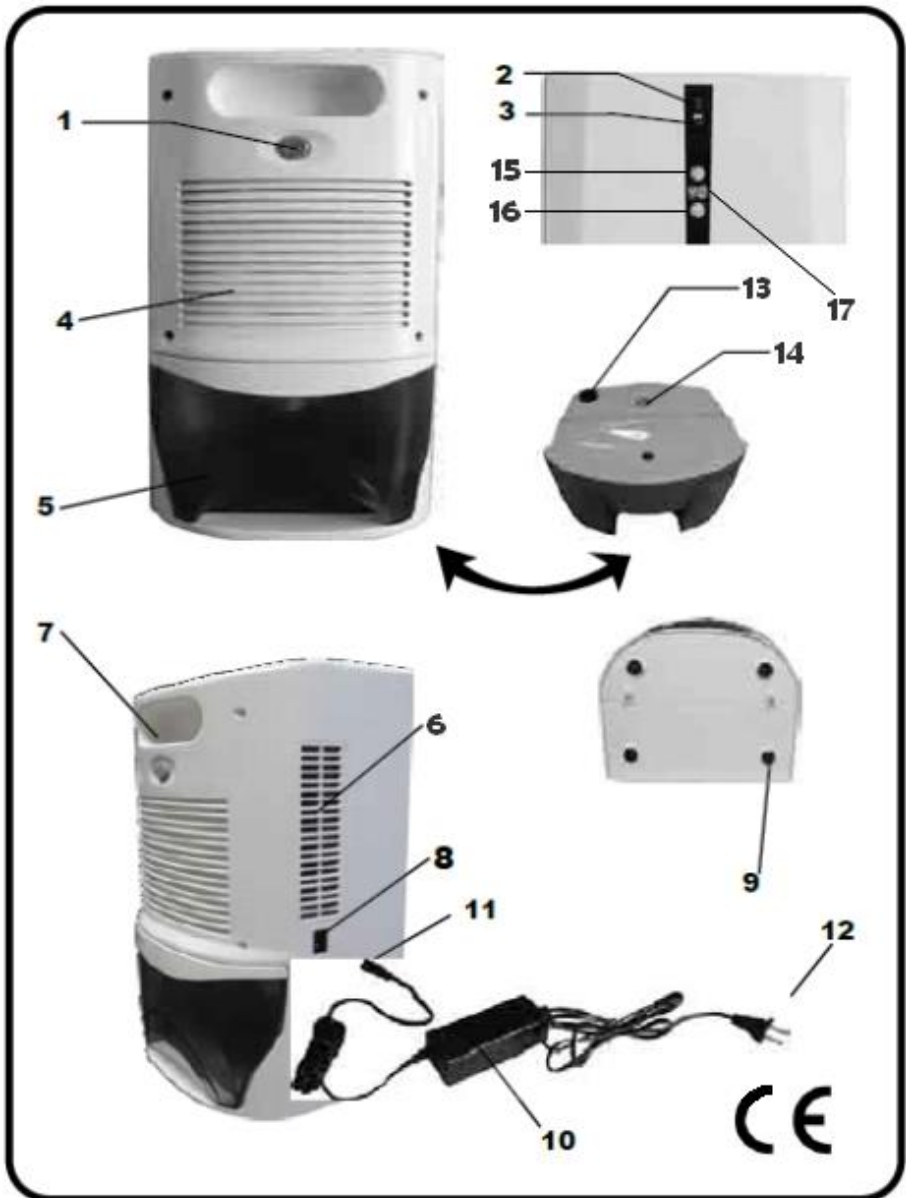

- (1) On/Off switch
- (2) Operating light (green)
- (3) Condensation tank full Light (yellow)
- (4) Air intake
- (5) Condensation tank
- (6) Fan / Air outlet
- (7) Carrying handle
- (8) Mains connection
- (9) Rubber feet
- (10) Power supply unit
- (11) Power connector for unit
- (12) Mains plug for socket
- (13) Condensation water spout plug
- (14) Float
- (15) Button (arrow up) to increase the target humidity value
- (16) Button (arrow down) for lowering the target humidity value
- (17) Humidity display, in flashing mode the selected target humidity value is displayed for approx. 10 seconds

Functional description:

The intelligent mini dehumidifier WDH-898MD uses a Peltier condensation technology (compressor-free Peltier principle without refrigerant). This technology has the great advantage of making the device small, quiet and light. Thus, this mini dehumidifier can also be used well in very small rooms, chambers and cupboards etc. !

Instructions for use:

1. Commissioning

- 1.1. Connect the power supply unit included in the scope of delivery properly to the dehumidifier. Make sure that the cable is completely unfolded. Then insert the mains plug properly into the socket.
- 1.2. Switch on the unit using the rear on/off switch. (*see illustration on the right*).
- 1.3. Check that the condensation tank is properly seated in the dehumidifier. (When using the dehumidifier for the first time, the "condensation tank full" light may come on. Simply pull the condensation tank out briefly and then push it right back in and you are ready to go).



1.4. Now press the arrow key (down ↓) below the front humidity display to set your target humidity value. After the first press, the humidity display starts flashing. You can now select your target humidity value in steps of 5% each (between 40% and 80%) by repeatedly pressing the respective arrow key (up ↑ / down ↓). The target value of 40% humidity usually corresponds to continuous operation. After approx. 10 seconds without pressing the arrow key again, the humidity display stops flashing automatically and the current ambient humidity value is displayed.

1.5. The front green operating light indicates that dehumidification is in progress.

2. Emptying the collection tank / When the "Condensation tank full" light (yellow) is on

When the condensation tank is full (after approx. 1.7 litres of tank capacity), the front yellow signal light lights up and the dehumidifier then automatically stops its dehumidification operation. Remove the condensation tank and then the condensation water drain plug. Now you can pour off/empty the accumulated condensate. After you have pushed the condensation tank neatly back into the unit, the dehumidification operation starts again automatically.

3. Other operating instructions

- 3.1. Do not disconnect the mains plug by pulling on the power cable !
- 3.2. Do not use insect, oil or paint spray etc. near the dehumidifier. This may cause damage to the unit or even fire !
- 3.3. Do not place the appliance on sloping or uneven ground !
- 3.4. Do not expose the power supply unit to direct moisture or steam. For example, do not place the power supply unit on a damp surface and ensure that there is sufficient air around the power supply unit so that it can dissipate its heat properly!
- 3.5. For effective and economical dehumidification operation, please close all doors and windows in the room where the dehumidifier is located !
- 3.6. Always hold and transport the unit in its proper and upright position !

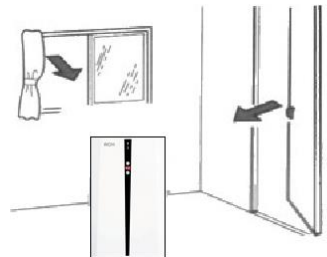
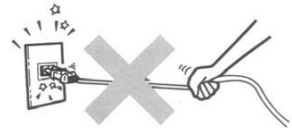

4. Cleaning

4.1. Cleaning the housing

- Before cleaning the dehumidifier, please unplug it from the mains and disconnect and remove the power supply.
- Only use mild cleaning agents to clean your dehumidifier.
- To clean the air vents, use a soft brush or carefully vacuum the air vents with a Hoover.
- NEVER spray your dehumidifier (e.g. with water or similar).

Technical data

Model name:	WDH-898MD
Voltage:	220 ~ 240V / 50-60Hz (power supply input)
Unit voltage:	15 V / 4 A (power supply output)
Max. Power consumption:	55 W
Condensation method:	Thermo-Electric Peltier Principle
Dehumidification capacity (optimal):	750 ml/day (30°C / 80% r.h.)
Dehumidification capacity (standard):	350 ml/day (20°C / 70% r.h.)
Condensation tank:	Approx. 1.7 litres
Protection class:	IP20
Dimension (H/W/D):	351 x 223 x 181 mm
Weight:	2,5 kg
Application range:	15°C ~ 35°C, minimum 40% RH.

We reserve the right to make deviations in the technical data!

Troubleshooting

The unit does not dehumidify enough / Too little water collects in the condensation tank

As with all dehumidifiers, the dehumidification performance is decisively influenced by the following factors:

A) humidity content of the room air and B) heat/temperature in the room.

Please remember that the primary aim is not to gain as much condensation water as possible, but to dry and/or keep dry the room air or ceilings, walls and inventory !

Furthermore, bear in mind that the dehumidifier can only remove moisture from the air and only indirectly from materials. Depending on the condition of the ceilings, walls and fixtures, it may take several weeks for the stored moisture to be released back into the air! For this reason, we also recommend that if you use your own humidity meter (hygrometer), it should be installed as freely as possible and should be placed somewhat away from walls and ceilings, because otherwise the determined humidity value of the room air will be falsified !!!

Other

Warranty statement:

Notwithstanding the statutory warranty claims, the manufacturer grants a warranty in accordance with the laws of your country, but at least 1 year (in Germany 2 years for private individuals). The warranty begins on the date of sale of the appliance to the end user.

The guarantee only covers defects that are due to material or manufacturing faults.

Warranty repairs may only be carried out by an authorised customer service. To make a warranty claim, please enclose the original sales receipt (with date of sale).

Excluded from the guarantee are:

- Normal wear
- Improper applications, such as overloading the appliance or non-approved accessories.
- Damage due to external influences, use of force or foreign objects
- Damage caused by non-observance of the operating instructions, e.g. connection to an incorrect mains voltage or non-observance of the assembly instructions.
- Completely or partially dismantled units

Conformity:

The dehumidifier has been tested and itself and/or parts thereof have been manufactured under the following (safety) standards:

Of course with CE (LVD + EMC) conformity.

LVD conformity tested according to:

EN 60335-1:2012+A11:2014+A13:2017+A1:2019
+A2:2019+A14:2019+A15:2021
EN 60335-2-40:2003+A11:2004+A12:2005+A1:2006
+A2:2009+A13:2012
EN 62233:2008

EMC conformity tested according to:

EN IEC 55014-1:2021
EN IEC 61000-3-2:2019+A1:2021
EN IEC 61000-3-3:2013+A1:2019+A2:2021
EN IEC 55014-2:2021
EN 61000-4-2:2009
EN IEC 61000-4-3:2020
EN 61000-4-4:2012
EN 61000-4-5:2014+A1 :2017
EN IEC 61000-4-6:2022
EN IEC 61000-4-11:2020

Correct disposal of this product:



Within the EU, this symbol indicates that this product should not be disposed of with household waste. Waste equipment contains valuable recyclable materials that should be recycled. Furthermore, the environment or human health should not be polluted by uncontrolled waste disposal.

Please dispose of

Therefore, dispose of old appliances via suitable collection systems or send the appliance for disposal to the place where you bought it. They will then recycle the appliance.

I wish you much pleasure with this appliance.

Your Aktobis AG

Keep these instructions for use in a safe place !